

RANGE DL

EN 15154-1 EN 15154-2

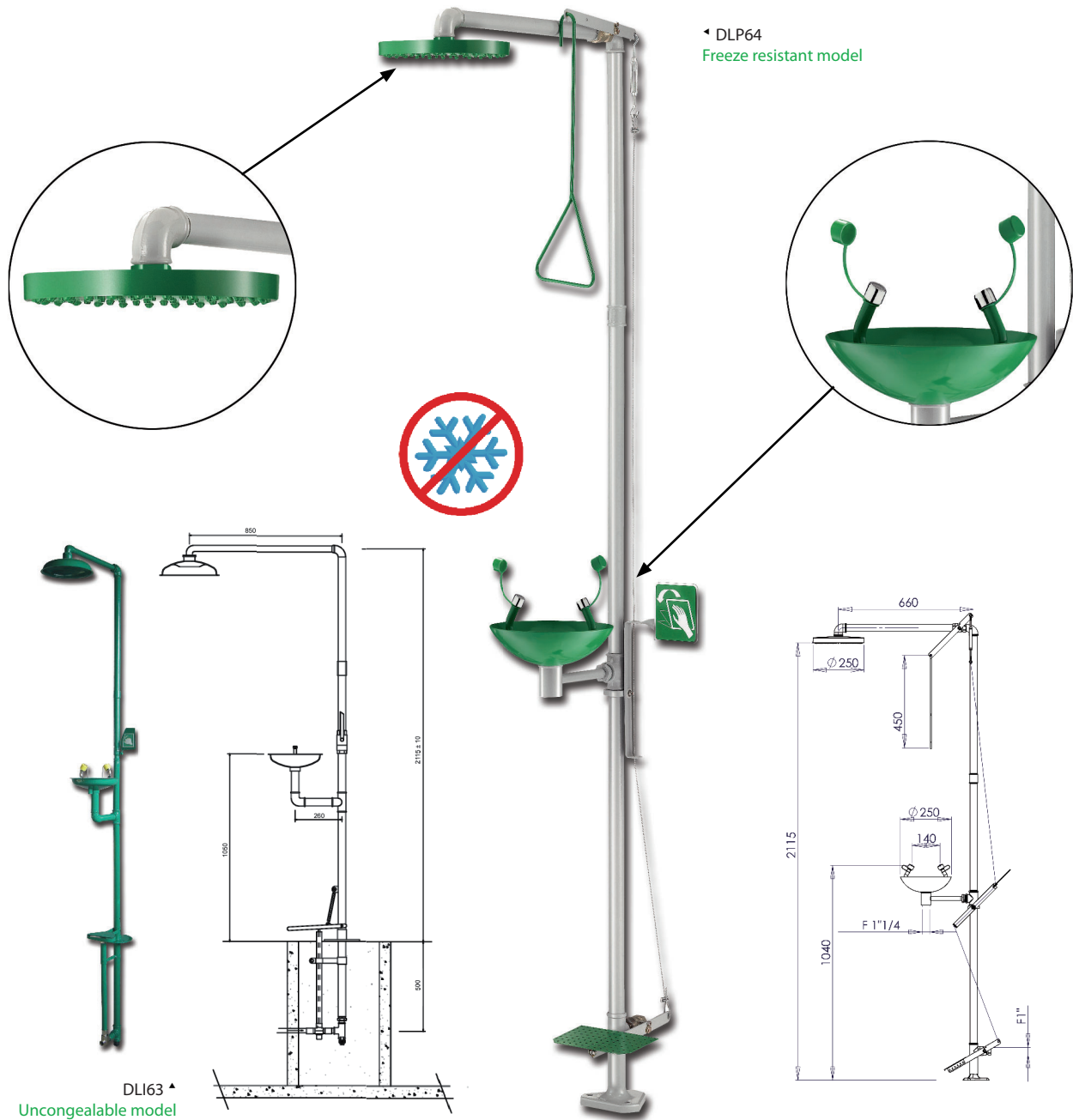

SAFETY COMBINATION UNITS



◀ DLP64
Freeze resistant model

DLI63 ▲
Uncongealable model

P/N	Use	Operating	Mounting	Bowl	Shower head	Piping	Supply	Draining	Flow (L/mn)		Weight (kg)	EN 15154-1	EN 15154-2
									Eye-washer	Shower			
DLP64	Indoor and outdoor ⁽¹⁾ 	Hand and foot operating	Pedestal mounted	Stainless steel + green epoxy paint RAL 6032	Green ABS RAL 6032	Galvanised steel + grey epoxy paint RAL 7040	F1"	F 1 1/4"	11,5	90	14	yes	yes
DLI63	Outdoor 	Hand and foot operating	Pedestal mounted	Green ABS RAL 6029 BAS6029	Green ABS RAL 6029	Galvanised steel + green epoxy paint RAL 6029	F1"	F 1 1/4"	11.5	75	24	yes	yes

⁽¹⁾ We recommend to install a heating cable kit with this model (KITCC)

The manufacturer reserves the right to discontinue or change specifications or designs at any time without notice and without incurring obligations. 11/2014



SAFETY COMBINATION UNITS



DLV43

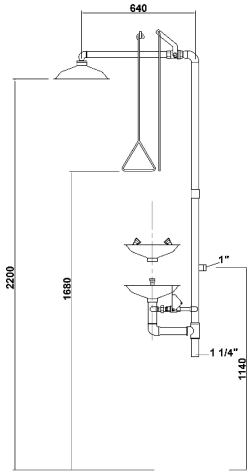

DLP62

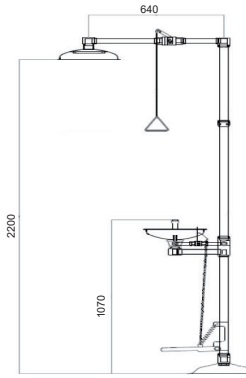

DLV52

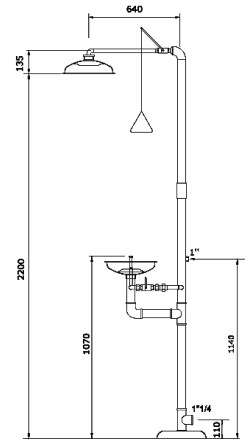

DLI83

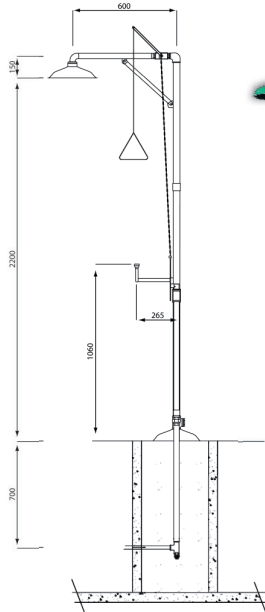

DLP63

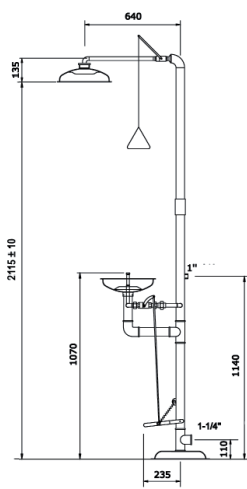

DLV53

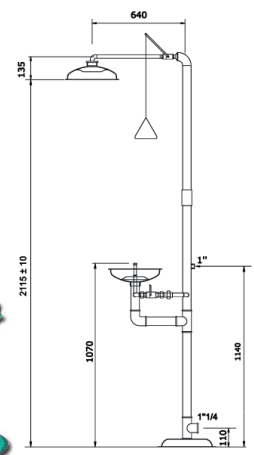

P/N	Use	Operating	Mounting	Bowl	Shower head	Piping	Supply.	Draining	Flow (L/mn)		Weight (kg)	EN 15154-1	EN 15154-2
									Eye-washer	Shower			
DLV43	Indoor	Hand operating	Wall	Green ABS RAL 6029	Green ABS RAL 6029	Galvanised steel + green epoxy paint RAL 6029	F1"	F 1 ¼"	11.5	75	19	yes	yes
DLV52	Indoor	Hand operating	Pedestal mounted	Stainless steel	Stainless steel	Stainless steel	F1"	F 1 ¼"	11.5	75	19	yes	yes
DLV53	Indoor	Hand operating	Pedestal mounted	Green ABS RAL 6029	Green ABS RAL 6029	Galvanised steel + green epoxy paint RAL 6029	F1"	F 1 ¼"	11.5	75	19	yes	yes
DLP62	Indoor	Hand and foot operating	Pedestal mounted	Stainless steel	Stainless steel	Stainless steel	F1"	F 1 ¼"	11.5	75	22	yes	yes
DLP63	Indoor	Hand and foot operating	Pedestal mounted	Green ABS RAL 6029	Green ABS RAL 6029	Galvanised steel + green epoxy paint RAL 6029	F1"	F 1 ¼"	11.5	75	23	yes	yes
DLI83	Outdoor	Hand operating	Pedestal mounted	-	Green ABS RAL 6029	Galvanised steel + green epoxy paint RAL 6029	F1"	F 1 ¼"	11.5	75	36	yes	yes

The manufacturer reserves the right to discontinue or change specifications or designs at any time without notice and without incurring obligations. 07/2019

Flammable cabinets

Corrosive cabinets

Toxic cabinets and multirisk

Pesticide range

Fume hoods, filtering cabinets - Ventilation

Containment and Cans

Anti-fire equipments and Files cabinets

Showers and first-aid equipments

Flammable cabinets

Corrosive cabinets

Toxic cabinets and multirisk

Pesticide range

Fume hoods, filtering cabinets - Ventilation

Containment and Cans

Anti-fire equipments and Files cabinets

Showers and first-aid equipments

RANGE DL

EN 15154-1 EN 15154-2

Ex II 2/G



SAFETY COMBINATION UNITS ATEX



DL192 ▶

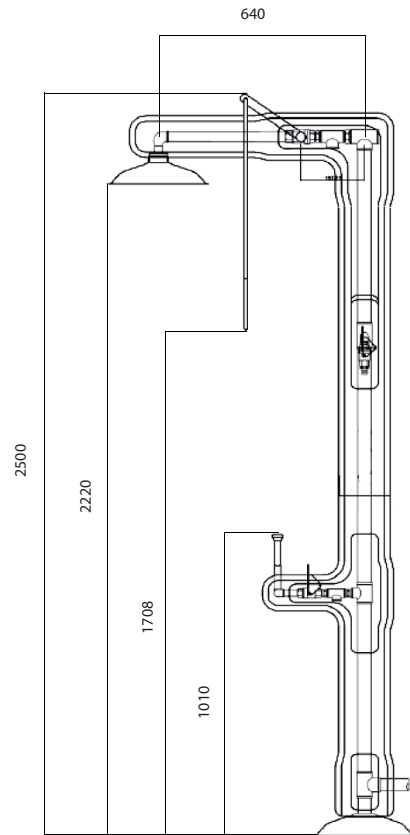

CONFORMITY

- Shower according to European Standard EN 15154-1
- Eye washers in accordance with European Standard EN 15154-2
- ATEX certified II 2 / G handset
- Standardized pictograms according to ISO 3864, NF X08.003, and European Directive 92/58 / CEE

INCLUDES

- Visual and audible alarm
- ATEX mechanical thermostat

P/N	Use	Operating	Mounting	Bowl	Shower head	Piping	Supply	Drain- ing	Flow (L/mn)		Weight (kg)	EN 15154-1	EN 15154-2
									Eye washer	Shower			
DL192	Indoor and outdoor	Hand operating	Pedestal mounted	-	Stainless steel	Stainless steel	F1"	F 1 ¼"	6	60	40	yes	yes

⁽¹⁾ Total weight with packaging: 100 kg. Package 2600 x 1100 x 630

The manufacturer reserves the right to discontinue or change specifications or designs at any time without notice and without incurring obligations. 03/2017